

RECYFIX® POINT FASERFIX® POINT STANDARD

POINT DRAINAGE.

FOR GARDENS, GARAGES AND RESIDENTIAL AREAS.

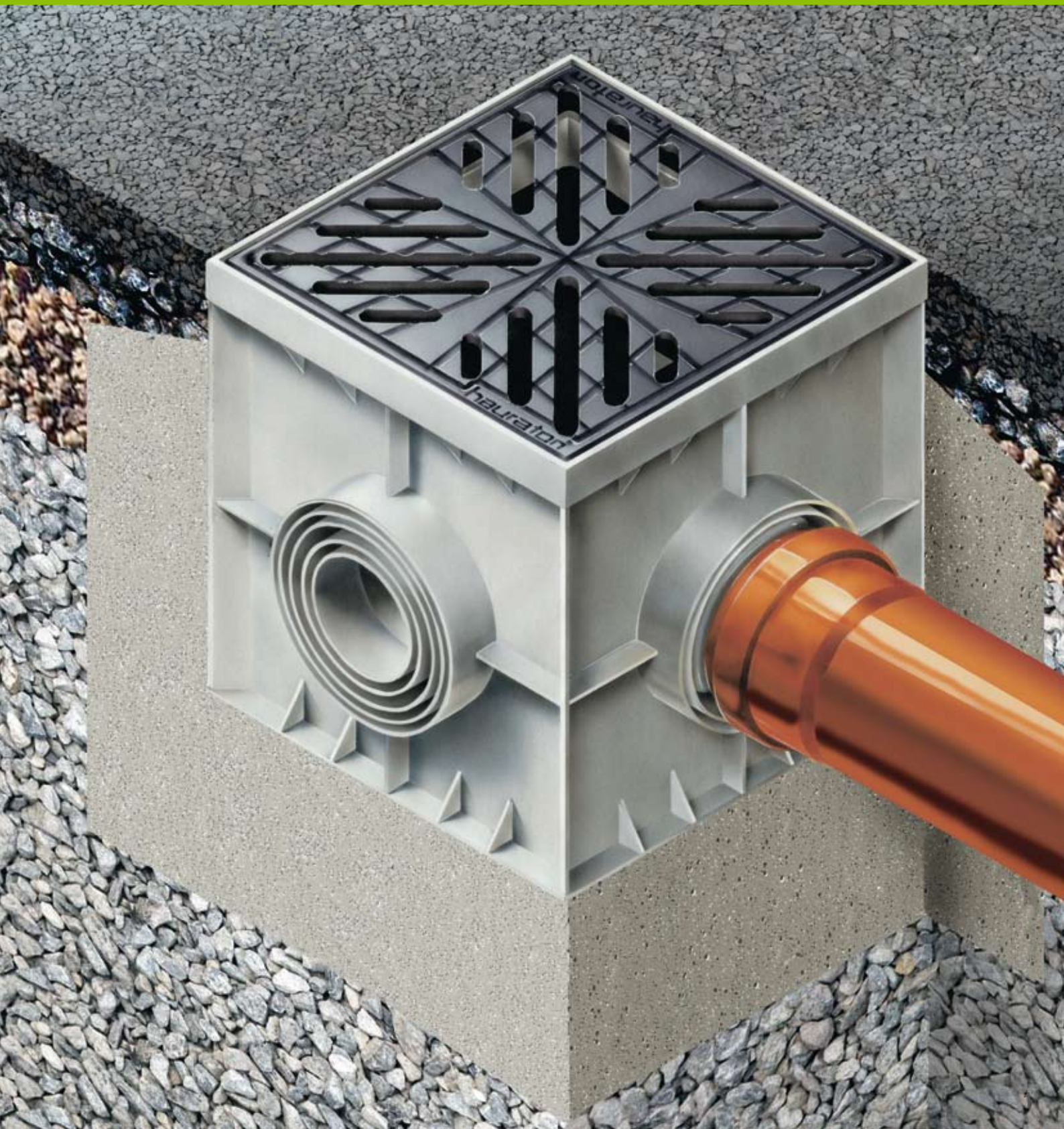



AT A GLANCE

- ✓ RECYFIX POINT made of high-quality polypropylene
- ✓ FASERFIX POINT STANDARD made of fibre-reinforced concrete
- ✓ For heavy rains or large quantities of melt water
- ✓ Ideal for all paved yards, drives and pathways, wash stations and car repair workshops

RECYFIX®POINT FASERFIX®POINT STANDARD

POINT DRAINAGE.

FOR GARDENS, GARAGES AND RESIDENTIAL AREAS.

REQUIREMENTS

After prolonged periods of rain, heavy rainfalls or melting snow, yards and other areas can flood very quickly. RECYFIX POINT and FASERFIX POINT STANDARD yard gullies provide a simple and effective solution. And in terms of durability and strength the point gullies from HAURATON meet all requirements.

SOLUTION

RECYFIX POINT and FASERFIX POINT STANDARD yard gullies are reliable drainage gullies with an attractive design for yards, driveways and other areas. To match the format of any adjoining paving they have been designed in a popular square format of 30 x 30 cm.

The yard gullies are made either from polypropylene or from fibre-reinforced concrete. Both materials guarantee a very long service life. Owing to its small weight of only 2.5 kg, the RECYFIX POINT yard gully is easy to transport and install. It can be connected to any common ground drainage pipes. Preformed pipe outlets on all four sides make the connection to all common pipe formats easy. There is a choice of two different gratings. The star design of the high-quality cast iron grating is particularly attractive as a focal point. The other option is a mesh grating in galvanised steel.



A point drainage set includes a mud bucket and an immersion baffle as a foul air trap. The FASERFIX POINT STANDARD comes equipped with an integral PVC union connector in DN 100 with a sealing lip for connecting to the ground drainage pipe.

APPLICATION AREAS

FASERFIX and RECYFIX POINT gullies are designed for point drainage of paved or metalled commercial and domestic areas.



Special stainless steel grating

| | | | | | | | | | |
|---------------|-------------------|------------------|--------------------|-----------------------------------|----------|----------------------|-------------------------|-----------------|----------|
| RECYFIX® PLUS | RECYFIX® STANDARD | SLOTTED CAHNNELS | FASERFIX® STANDARD | RECYFIX® POINT FASERFIX® POINT | DACHFIX® | RECYFIX® GREEN SUPER | RECYFIX® GREEN STANDARD | RECYFIX® STREIF | LINEFIX® |
|---------------|-------------------|------------------|--------------------|-----------------------------------|----------|----------------------|-------------------------|-----------------|----------|

RECYFIX®POINT 30/30

RECYFIX®POINT 30/30 - Point drain

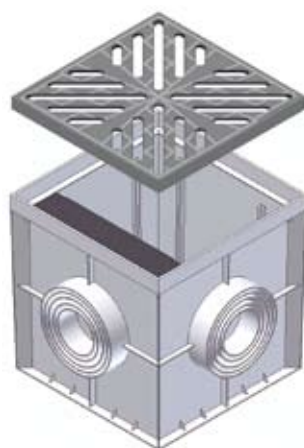

with ductile iron grating,
star design, black

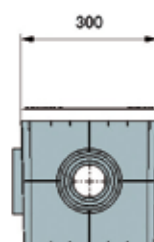
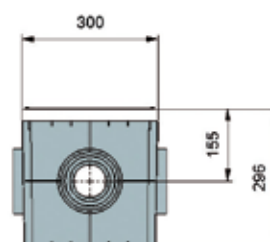

| | Length mm | Width mm | Height mm | Weight kg | Article No. |
|--|--------------|-------------|--------------|--------------|----------------|
| with ductile iron grating, star design, black | 300 | 300 | 300 | 7,6 | 185 |
| with mesh grating, MW 30/15, galvanised | 300 | 300 | 300 | 4,2 | 183 |
| Upper part made of Polypropylene, heighth 120 mm | 300 | 300 | 120 | 0,7 | 178 |

FASERFIX®POINT 30/30 - Point drain

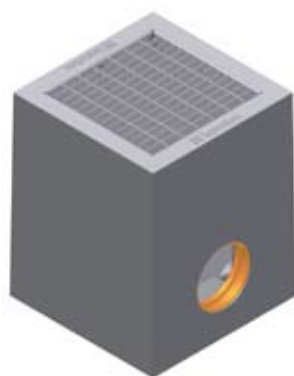

with mesh grating MW
30/15, galvanised

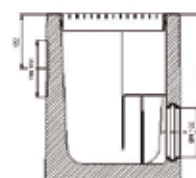
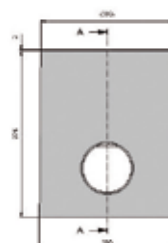

| | Length mm | Width mm | Height mm | Weight kg | Article No. |
|--|--------------|-------------|--------------|--------------|----------------|
| with mesh grating MW 30/15, galvanised | 300 | 305 | 375 | 35,5 | 4430 |